



Color Magic

2,700 pax Cruise Ship
with a car deck

Preferred for innovation





Color Magic

– another ship of superlatives

Aker Yards, an experienced builder of passenger ships, delivered in 2004 a big cruise ship with a car deck for Norwegian cruise ferry operator Color Line. With a 2,700 passenger capacity and 2,240 lane metres vehicle deck space the Color Fantasy is really a ship of superlatives, being the largest, longest, widest and most expensive cruise ship with a car deck in the world. Now another ship of superlatives is delivered. The sister vessel, MS Color Magic operates on the same routes as the Color Fantasy having a wide variety of entertainment and conference areas. The number of cabins is higher than on Color Fantasy.



1.



2.



3.

1. Owner's suite
2. Magic Show Lounge
3. Owner's suite, bathroom

Like her sister, the Color Magic is custom-designed to carry out shorter cruises. The layout of the vessel is spread over 16 decks, and there are 1,016 passenger cabins, of which 60% are window cabins and 46 suites. All cabins have TV and mini bar. In addition, there are 298 crew cabins. The vessel can accommodate up to 750 cars, and there are also 1,270 lane metres for trucks and trailers. The ship has a length of 223.7 m and a beam of 35 m (41.4 m between bridge wings). It has a design draught of 6.8 m and a height to deck seven of 21.9 m. It registers 75,100 GT and has a 4,860 t deadweight.

Along the length of the vessel is a three decks high Magic Promenade, a 160-meter long promenade and main communicating space, which is considered the very heart and soul of the ship and counted as the major feature of the Yard's design. It connects the panorama lifts, voids and stairs at each end and all the shops, restaurants and facilities there. Embarkation is directly to the promenade. The promenade has a multi-purpose function: besides a communicating space it is an area for parades and other happenings and lively interaction of guests onboard. Through

lighting and effects the promenade is easily converted to different atmospheres as day, night, informal, formal, party time etc. The Promenade contains four restaurants: The Oriental Café, Tapas Bar, Mama Bella Pizza Ristorante and The Monkey Pub. Fashion Boutique, Color Shop, Perfume and Cosmetics, 24H Kiosk, children playroom Kid's Corner and reception are also situated in the Promenade area.

The Magic Show Lounge presents two shows per evening. For dining, the guests can choose between eight different restaurants – from a private dining saloon in the Manhattan Gourmet to the Sports and Burger Bar. Among several bars is the Observation Lounge on the upper deck.

The Color Spa and Fitness Centre includes comprehensive gym and spa facilities with spa treatments, hair salon, jacuzzi, steam bath, sauna and massage chairs.



1. Aqualand
2. Color Spa & Fitness Centre
3. Color Magic on her route between Oslo and Kiel
4. Oceanic à la Carte



Technical Particulars

Shipbuilder	Aker Yards
Vessel's name	Color Magic, hull No. 1355
Owner	Color Line
Country	Norway
Flag	Norway
Route	Oslo - Kiel
Length oa	223.7 m
Length bp	202.7 m
Breadth moulded	35.0 m
Breadth max	41.4 m
Dept moulded	to main deck 9.7 / 9.5 m (D3) to upper deck 21.9 m (D7)
Draught	scantling 7.0 m design 6.8 m
Speed, service	22 kn
Gross Tonnage	75,100
Deadweight design	4860 t (1.025 t/m 3)
Number of decks	16
Height, max from BL	59.2 m

Classification society and notations:

Det Norske Veritas
+ 1A1 Car Ferry A, ICE-1B (1A, except propeller blades 1B),
RP, E0, MCDK, pwdk, NAUT-OC, F-M, COMF-V(1) Pass&Crew, CLEAN,
TMON, VIBR

Complement	Officers 47, Crew 251
Passengers	2700
Number of cabins	Total 1314 1016 pass. cabins (60% / 607 window cabins), 298 crew cabins

Diesel-mechanical propulsion

Main engines	4 x 7800 kW, 500 rpm
Propellers	2 x CPP
Shaft generators	2 x 4800 kW (for manoeuvring)
Thrusters	bow 3 x 2200 kW stern 2 x 1000 kW

Auxiliary engines 4 x 2040 kW, 1000 rpm

RoRo capacity:

trailer lanes	1265 m (width 3.1m)
car lanes	1190 m (on hoistable car decks, width 2.2m)

Elevators 19 pcs (14 for passengers)

General arrangement

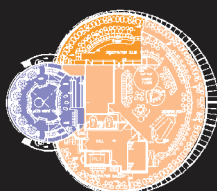
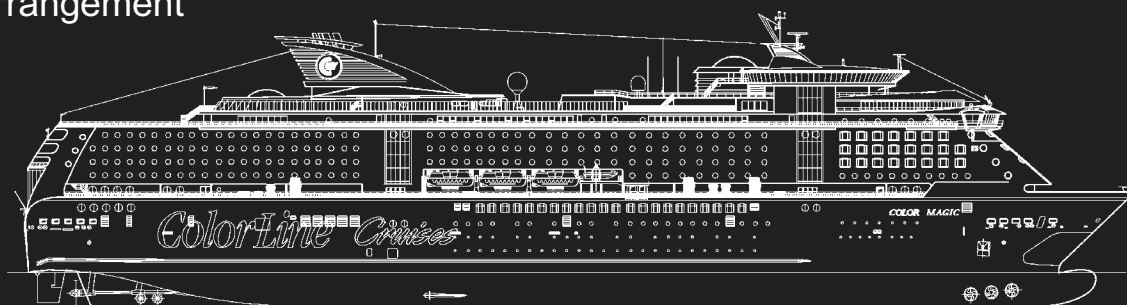

- Observation Club
- Night Club
- Observation Lounge

DECK 15

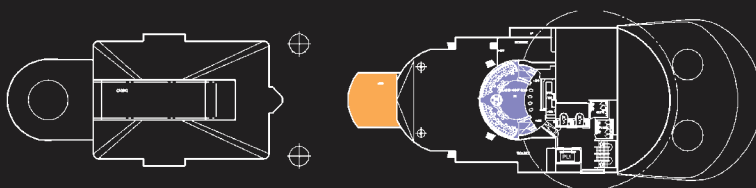

- Sun deck
- Night Club

DECK 14

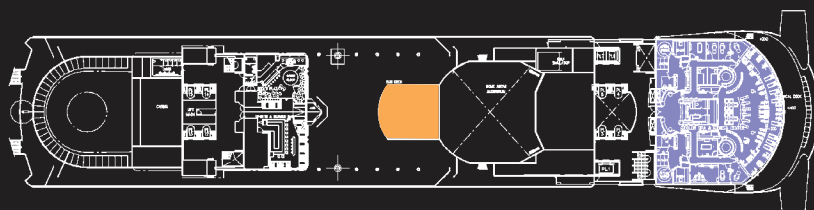

- Color Spa & Fitness Centre
- Sun deck

DECK 13

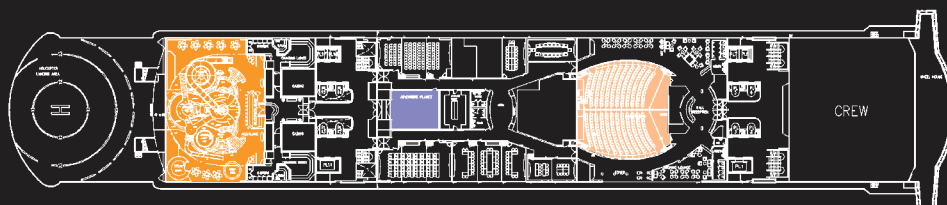

- Auditorium
- Adventure planet
- Aqualand

DECK 12

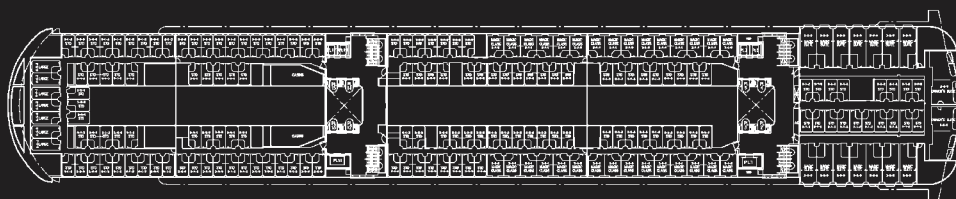

DECK 11

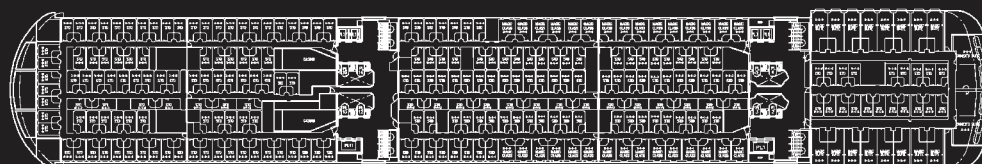

DECK 10

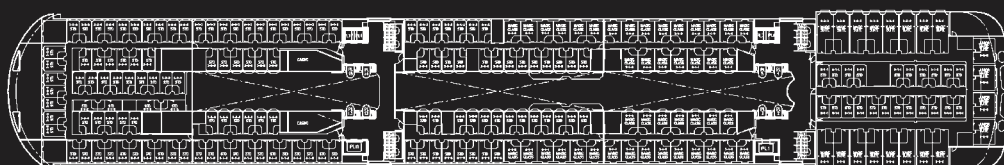

DECK 9

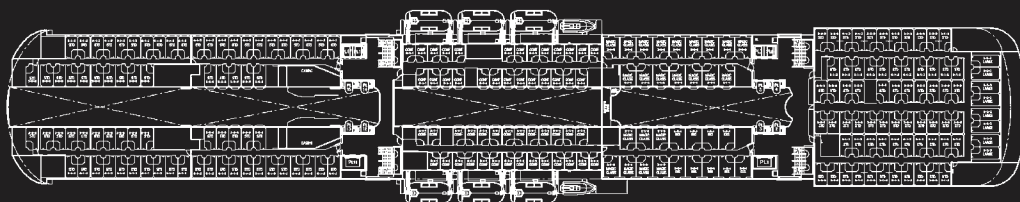

DECK 8

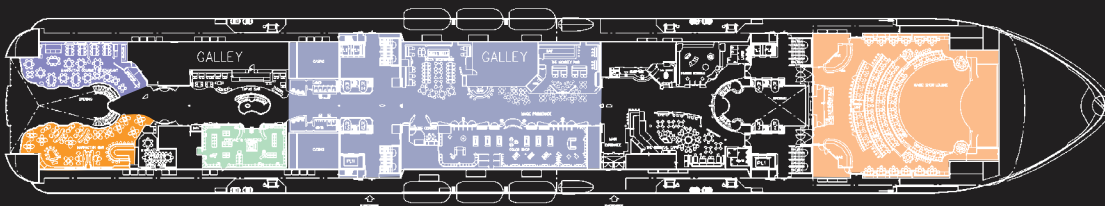

DECK 7

- Gourmet Restaurant
- Manhattan Bar
- Magic Promenade
- Perfume & Cosmetics
- Magic Show Lounge

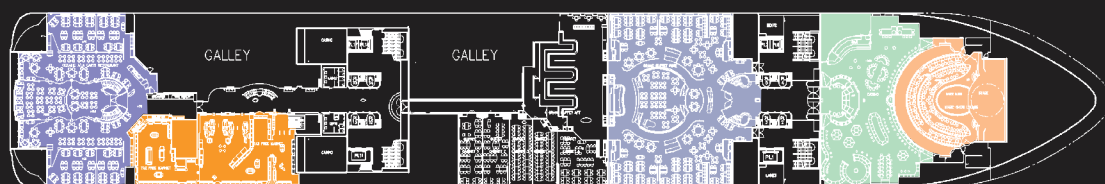

DECK 6

- Oceanic à la Carte
- Tax free Market
- Grand Buffet
- Casino
- Magic Show Lounge

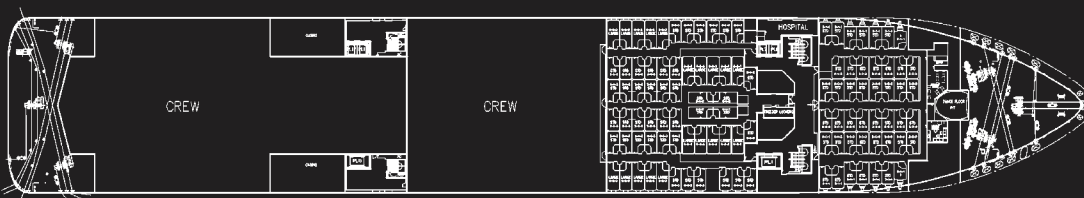

DECK 5

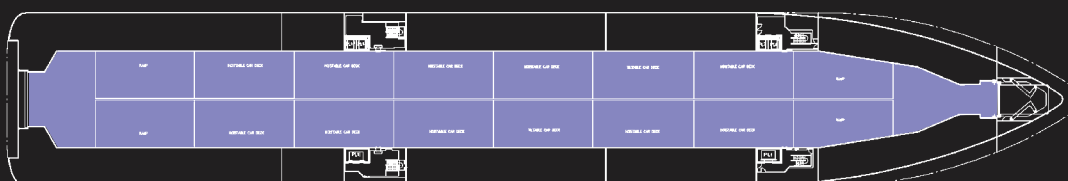

DECK 4

- Car deck

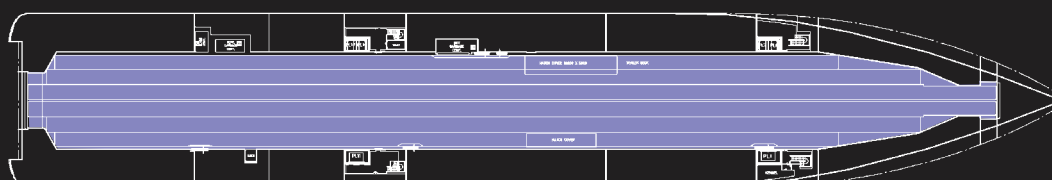

DECK 3

- Trailer deck

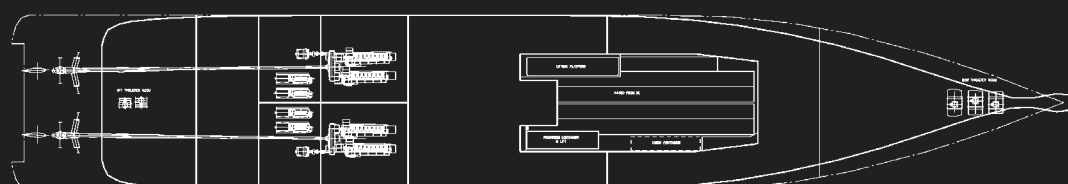

DECK 2



1.



2.



3.

1. Oceanic à la Carte
2. Night Club
3. Auditorium
4. Observation Cafe
5. Observation Lounge



4.



5.

Aker Yards ASA is an international shipbuilding group focusing on sophisticated vessels. The group has a strong position both in terms of innovation, product range, technology, experience and capacity. The product range includes cruise vessels & ferries, merchant vessels, offshore & specialized vessels. Aker Yards comprises 18 yards in Brazil, Finland, France, Germany, Norway, Romania, Ukraine and Vietnam. Aker Yards has approximately 20,000 employees.

Aker Yards, Cruise & Ferries

P.O. Box 666

FI-20101 Turku, Finland

Tel. +358 (0)10 6700, Fax +358 (0)10 670 6700

cruiseferries@akeryards.com

www.akeryards.com

